

**Aperto lateral de painéis**  
 (Side panel clamping)

**Aperto central de painéis**  
 (Middle panel clamping)

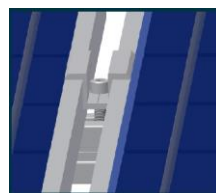
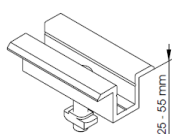
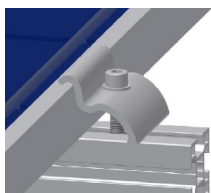
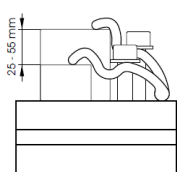

SIRSOLAR – Designed by SIR

<b>Dimensões C x L x H (mm)</b>	600 x 150 x 296
<b>Peso (kg/peça)</b>	33
<b>Betão</b>	Cinza
<b>Acabamento</b>	Rugoso
<b>Tratamento Superfície</b>	n.a
<b>Materiais Complementares</b>	mangas de ancoragem inox M8 Acessórios alumínio p/ fixação Painéis
<b>Instalação</b>	Simplemente apoiado
<b>Normas aplicáveis</b>	NP EN 206-1

<b>Dimensions C x L x H (mm)</b>	600 x 150 x 296
<b>Weight (kg)</b>	33
<b>Concrete</b>	Grey
<b>Finishing</b>	Rough
<b>Treatment</b>	n.a
<b>Other materials</b>	M8 stainless anchor sleeves Aluminum accessories for fixing panel
<b>Standing</b>	Self standing
<b>Applicable Norms</b>	EN 206-1