



Maciço Sinal Alto



Maciço Sinal Baixo



Maciço TCM

<b>Utilização prevista</b>	Vias ferroviárias
<b>Betão</b>	EN 206-1 C30/37 XC2(PT) Cl.0.1 D <sub>máx.</sub> 14;
<b>Aço</b>	A500 ER
<b>Acabamento</b>	Rugoso
<b>Nota</b>	Aresta superior quebrada
<b>Normas aplicáveis</b>	NP EN 206-1 • LNEC E464 • NP EN 13369

**Características Geométricas:**

Tipo	Largura (mm)	Altura (mm)	Peso/Peça Kg
Sinal Alto	600x400	1000	600
Sinal Alto Tipo II	600x450	1000	675
Sinal Baixo	600x425	700	337
Maciço TCM	340x340	300	120
Maciço VOC	1876x1150	700	2940
Sinal Manobras	400x270	600	337

Sinal Alto

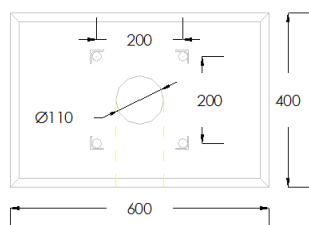

alçado frontal

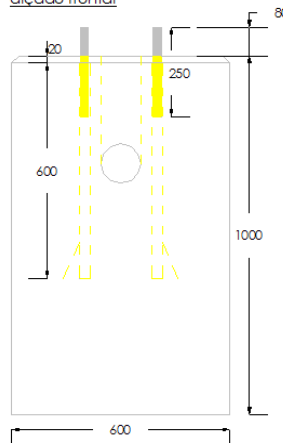

alçado lateral

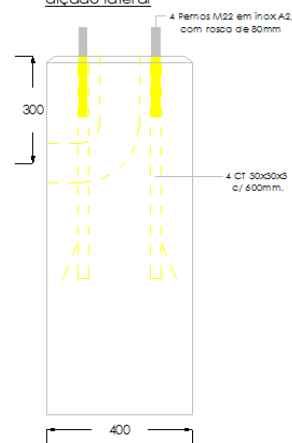

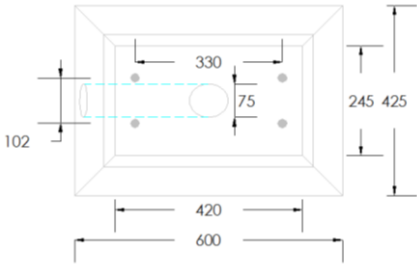
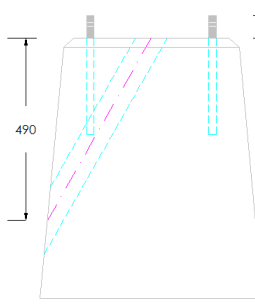
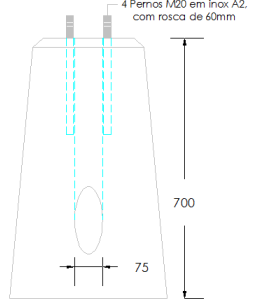
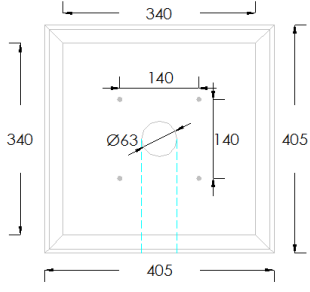
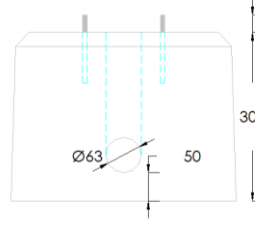
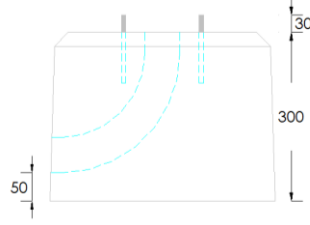
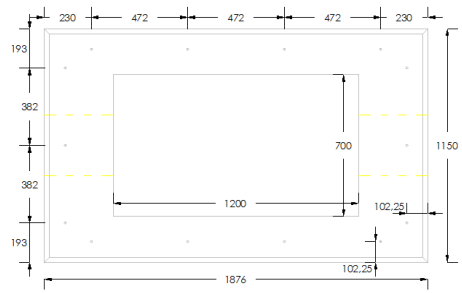
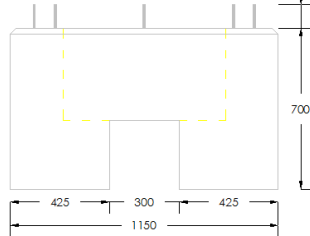
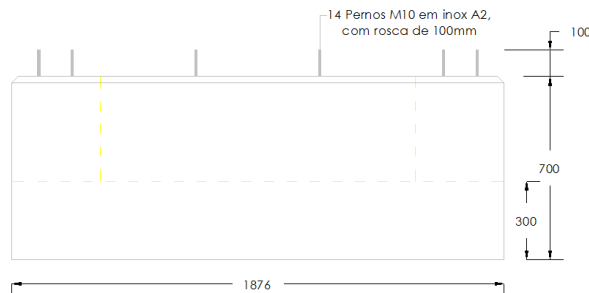
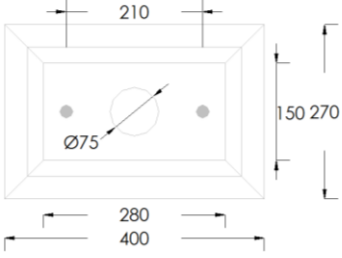
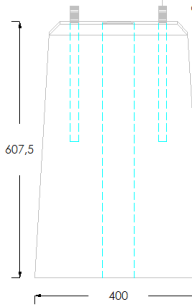
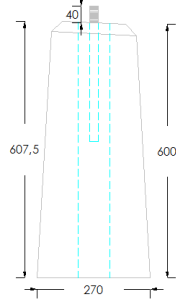
<p><b>Sinal Baixo</b></p>			 <p>4 Pernos M20 em Inox A2, com rosca de 60mm</p>
<p><b>Maciço TCM</b></p>			
<p><b>Maciço VOC</b></p>			 <p>14 Pernos M10 em inox A2, com rosca de 100mm</p>
<p><b>Sinal Manobras</b></p>			 <p>2 Pernos M20 em Inox A2, com rosca de 40mm</p>